

6. Operation guide when an Alert (Caution) /an Information occurred

Alert / Information

Alert: It is in a low level abnormal condition (Caution level), and attention is necessary.
 Information: It is not in an abnormal condition, but confirmation is necessary. (e.g. Battery expiry date is coming.)

If the Alert (Caution) occurs

- 

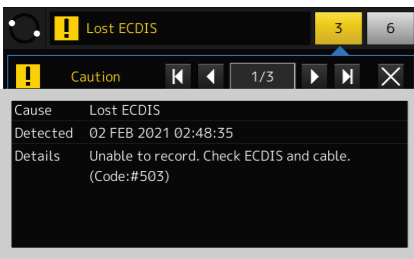
Tap the [ALERT] button. The number on the button indicates the number of alerts.
- 

Check the contents of alert.

 - Cause: indicates the cause of alert.
 - Detected: indicates the date and time that the alert occurred.
 - Details: indicates the contents of alert.
 - Code: indicates the error code.

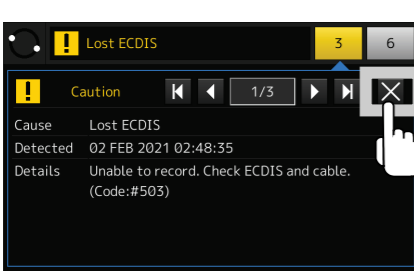
When there are multiple alerts, tap the left and right arrow buttons  to check other alerts.
- 

Confirm the occurred alert and tap the  button to close the alert screen.

If the Information occurs

- 

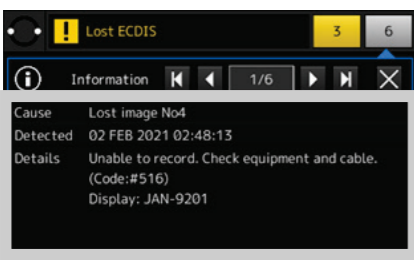
Tap the [INFORMATION] button. The number on the button indicates the number of Information.
- 

Check the contents of information.

 - Cause: indicates the notice title.
 - Detected: indicates the notice date and time.
 - Details: indicates the contents of the notice.
 - Code: indicates the code.

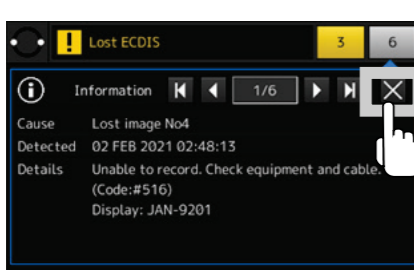
When there are multiple notices, tap the left and right arrow buttons  to check other information.
- 

Confirm the notice and tap the  button to close the information screen.



VDR JCY-1900 / S-VDR JCY-1950 Operation guide

1. Names and function

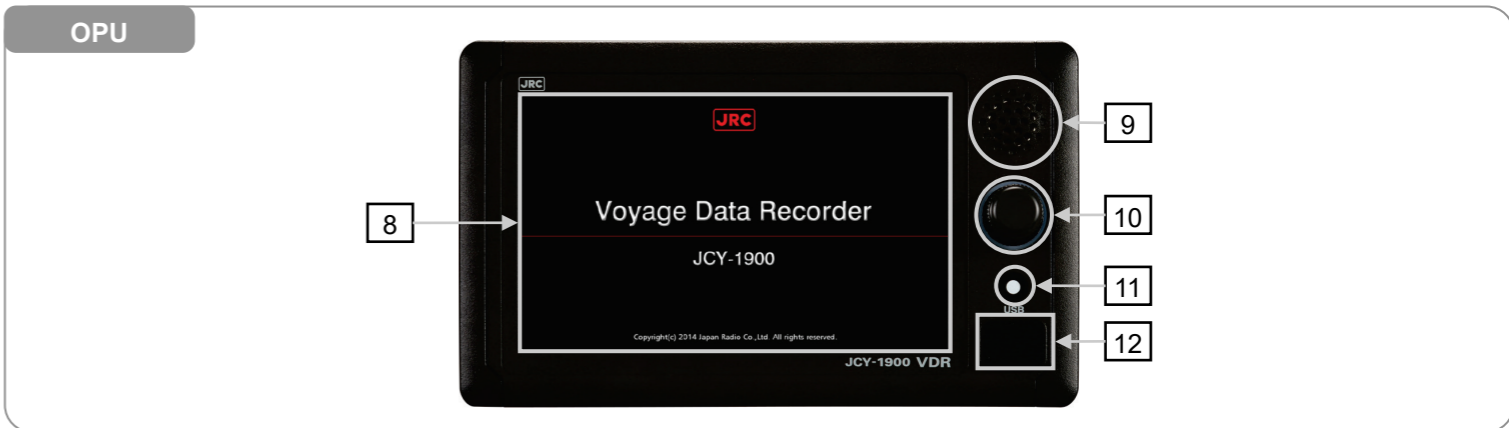
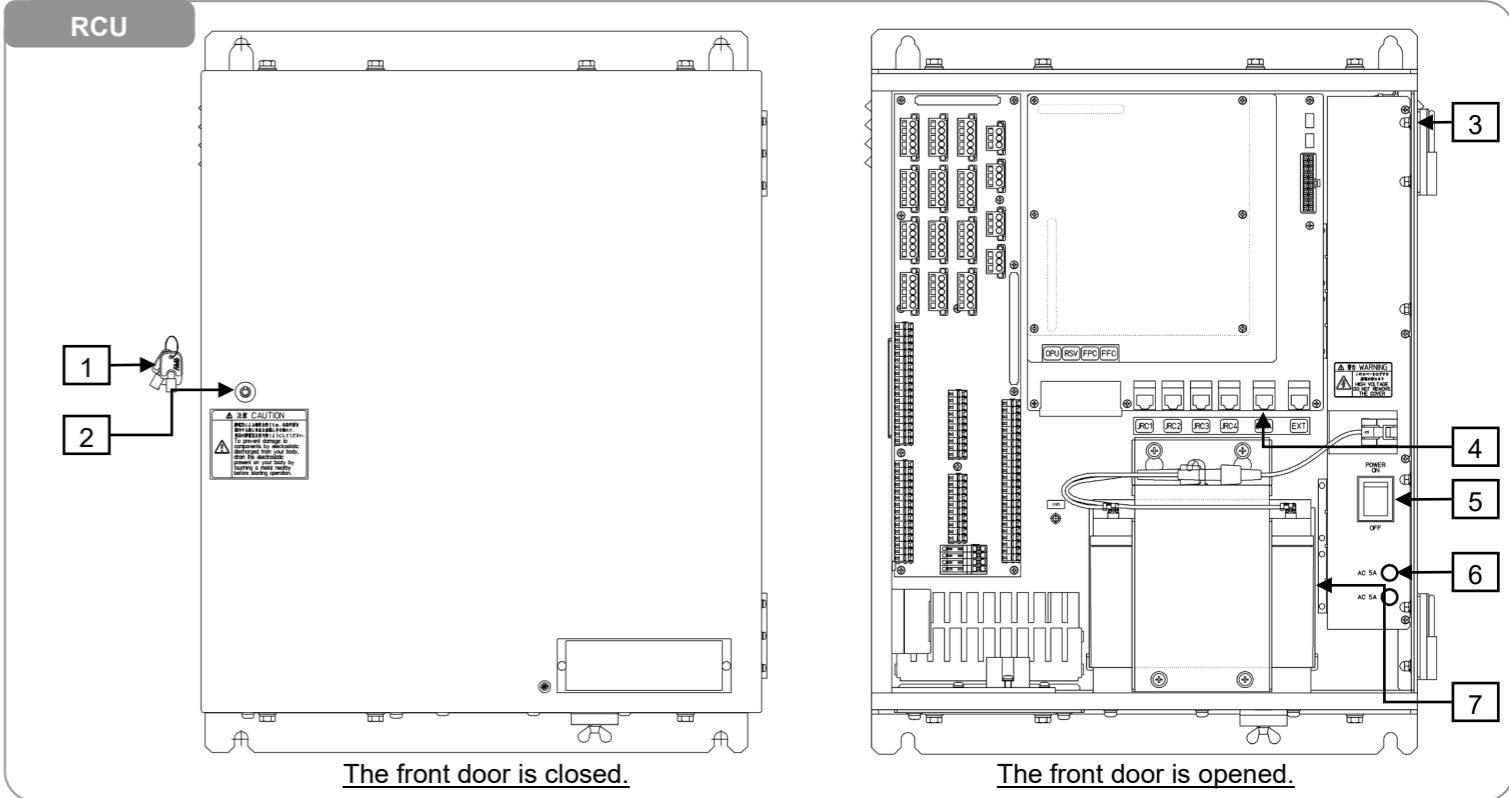

No.	Name	Function
1	Key	The key for the front door.
2	Keyhole	Insert the key.
3	Cooling fan	Two cooling fans are installed in the RCU.
4	DATA port	The accident investigator uses to retrieve the recorded data from the VDR.
5	POWER switch	This is the main power switch of the RCU.
6	Fuse	The glass fuse is mounted to protect the AC input power line. Current capacity: 5A / 250V
7	Battery	The battery becomes the backup power supply when an AC input power is lost.
8	Touch panel	Tapping the touch panel, can operate the VDR system.
9	Speaker	Sounds the operation sound and plays back the recorded conversation.
10	Rotary knob	The rotary knob can adjust the screen brightness. Furthermore, for the case of malfunction of touch panel, the OPU is operable with the rotary knob.
11	HOME button	If you would like to return to HOME screen, push the HOME button.
12	USB port	If you would like to copy data from internal storage, plug a FAT32 formatted USB flash drive in this port

2. Starting the VDR / S-VDR

- 1) Unlock and open the front door.
- 2) Turn on the POWER switch.

POWER switch

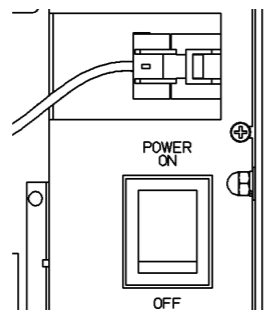

- 3) After approximately 2 minutes, make sure that the MCB's LED (SYS, REC) lights up in green.

LED position

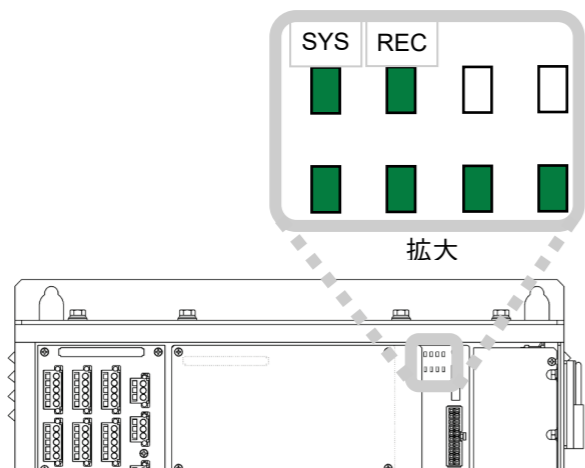

- 4) The OPU starts up and displays the startup screen.

Startup screen

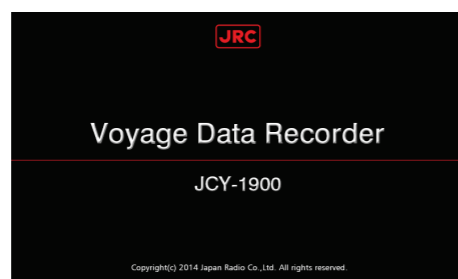

- 5) Close and lock the front door. Please keep the key carefully.

3. Stopping the VDR / S-VDR

- 1) Unlock and open the front door.
- 2) Turn off the POWER switch.

POWER switch

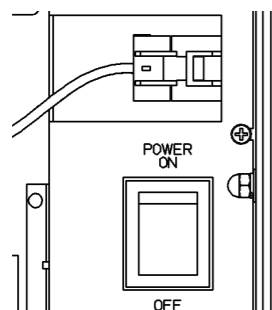

Do not stop the VDR / S-VDR, except the following case.

- During essential maintenance whilst the vessel is in port.
- When the vessel is laid-up.
- Upon request by an investigation authority, for example after the vessel had been involved in a marine incident.

- 3) After approximately 1 minute, make sure that the MCB's LED goes out.
- 4) Check that the OPU's screen disappears.
- 5) Close and lock the front door.

4. HOME screen

HOME screen

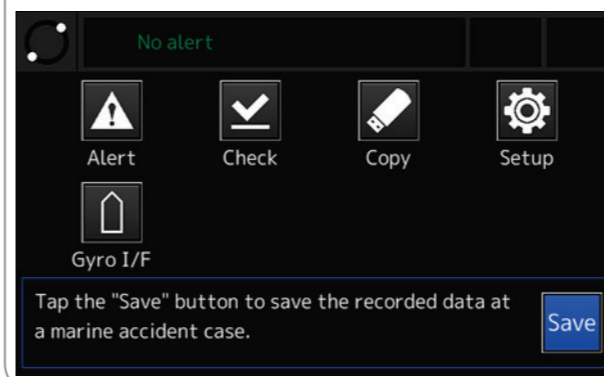

Button	Function	Description
Alert	Checking the alert	Display the ALERT screen. Check the alerts that are occurring.
Check	Checking the recorded data	Display the DATA CHECK screen. Check the connected units to the VDR system.
Copy	Copying the recorded data	Display the DATA COPY screen. Copy the recorded data to the USB flash drive.
Setup	Setting up the system	Display the SETUP screen. Check the VDR system settings and information.
Gyro I/F	Setting the initial ship's heading	Display the GYRO I/F screen. Enter the initial value of the ship's heading.

5. Operation guide when a maritime accident occurred

Preserving the recorded data

1)

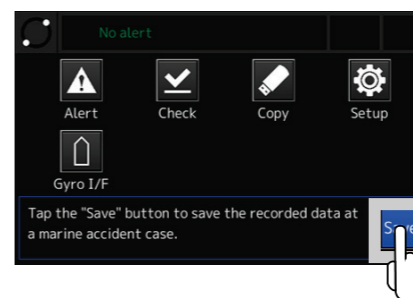

When a maritime accident occurred, please secure the "Save area" as the recorded data can be preserved immediately. The "Save area" are three area.

Tap the [Save] button in the HOME screen.

2)

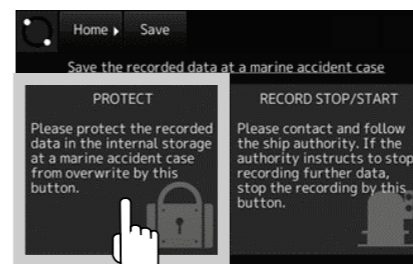

Tap the [PROTECT] button in the "Save the recorded data at marine accident case" screen.

3)

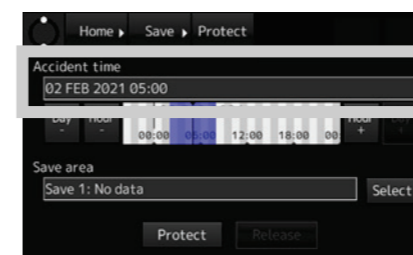

Check that the data and time of [Accident time] field in the DATA PROTECT screen is the current time.

[Information]
It is not usually necessary to change because the current time is set automatically.

4)



Tap the [Protect] button to preserve the recorded data.